

PARISH CHURCH OF ST MARY WOOLNOTH

No 1.

LOADARD STREET :

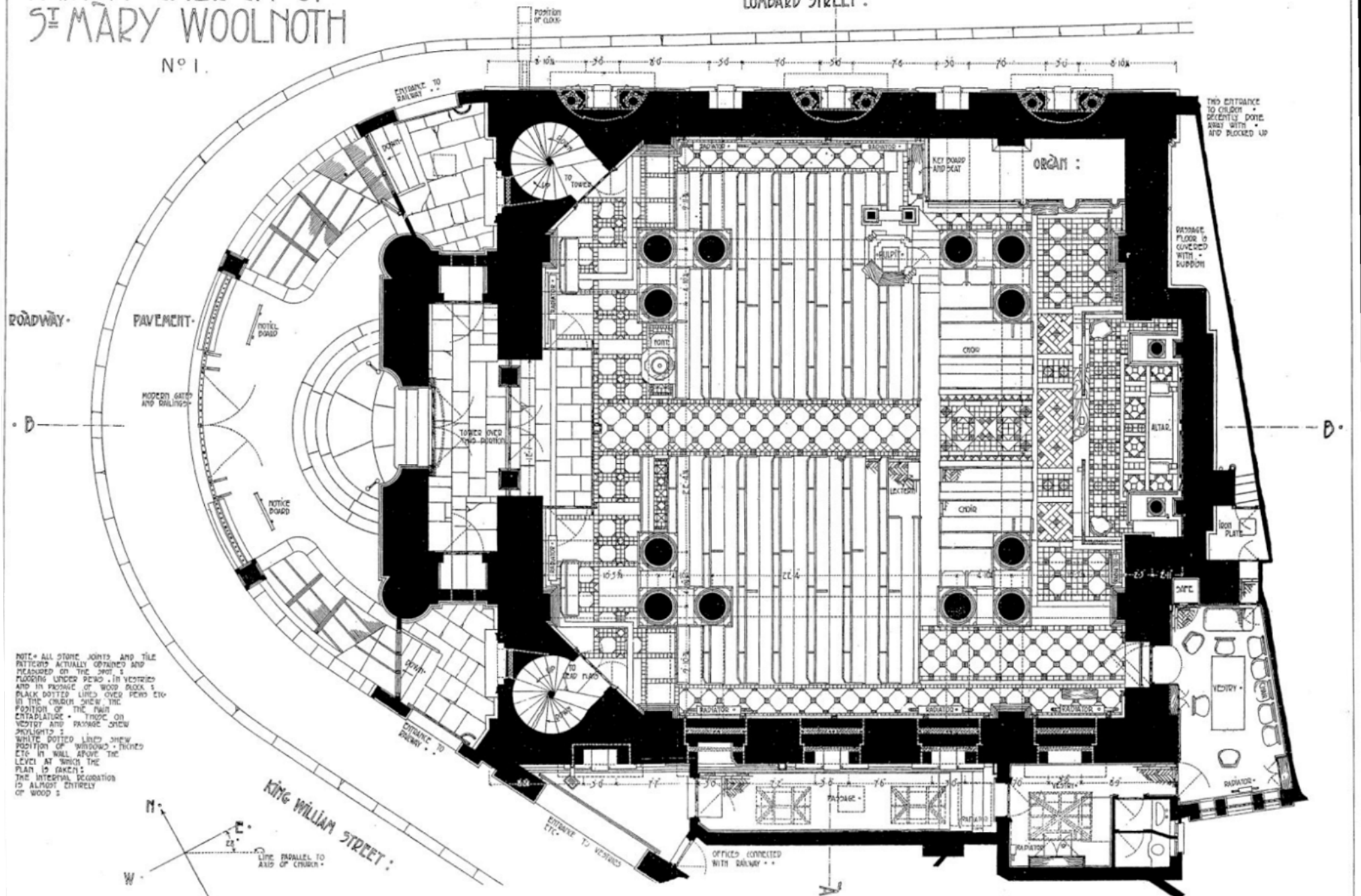

NOTE - ALL STONE JOINTS AND TILE PATTERNS ACTUALLY OBTAINED AND MEASURED ON THE SPOT. FLOORING UNDER PAVES IN VESTRY AND IN PASSAGE OF WOOD BLOCK & BLACK DOTTED LINES OVER PERS TO IN THE CHOIR SHOW THE POSITION OF THE PAIR ENTABLATURE. TRACE ON VESTRY AND PASSAGE SHOW PROLIGHTS. WHITE DOTTED LINES SHOW POSITION OF WINDOWS. TICKED LINES IN WALL ABOVE THE LEVEL AT WHICH THE PLAN IS TAKEN. THE INTERIOR DECORATION IS ALMOST ENTIRELY OF WOOD.

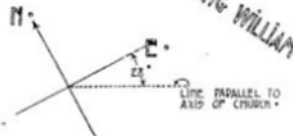

KING WILLIAM STREET :

MEASURED AND DRAWN BY
ALFRED C. BOSSOM, 1901

GROUND PLAN :

SCALE: 1 2 3 4 5 6 7 8 9 10 11 12 13 14 15 16 17 18 19 20 21 22 23 24 25 26 27 28 29 30 31 32 33 34 35 36 37 38 39 40 41 42 43 44 45 46 47 48 49 50 FEET.